

XtremeScan® Mag XS640

Rugged BYOD 1D/2D Barcode Scanner



The XtremeScan Mag XS640 stands out as a rugged, high performance barcode scanner designed for fast, accurate 1D/2D scanning in demanding environments. Based on Socket Mobile XtremeScan Mag platform, the XS640 is designed for BYOD (Bring Your Own Device) operations and seamless integration with any mobile device. It offers an optimal solution to enhance efficiency and convenience in mobile workforces. Featuring a secure magnetic attachment system, workers can easily attach and detach their personal mobile devices throughout the day. This flexibility empowers

users to switch between tasks such as navigation, photos, and communication, while adding high-performance 1D/2D barcode scanning when needed.

With its innovative BYOD design and rugged durability, the XS640 is ideal for modern delivery and inventory operations, ensuring tasks are completed efficiently without requiring multiple devices.

Featuring a streamlined case format, the XS640 offers a compact, easy-to-handle design for comfortable use over long shifts. Its fast, omnidirectional 1D/2D scanning delivers effortless data capture, and the secure magnetic attachment system allows for quick access when scanning is required. With extended battery life, military-grade durability to withstand drops and harsh conditions, and intuitive LED indicators, the XS640 simplifies scanning tasks while maintaining performance in any work environment.

Equipped with Bluetooth connectivity and a strong metal plate attachment system, the XS640 ensures optimal compatibility with any mobile device and reliable integration with iOS and Android business applications.

FEATURES

- **Multi-Device Compatibility** – Apple® Certified for iOS devices (iPhone®, iPad®) and compatible with Android, and Windows® 10.
- **Magnetic Attachment** – Securely holds any device in place using a compatible case or the included universal adapter, ensuring convenience and ease of use in various work environments.
- **Robust Scanning** – Fast 1D/2D scanning for both printed and on-screen barcodes, featuring omnidirectional capability for intuitive, rapid scanning.
- **Rugged Design** – Built to withstand drops and harsh environments, with an IP67 sealed housing for protection from dust, water exposure, and water immersion.
- **One-Handed Solution** - Easily combine the mobile device and data reader for a one-handed scanning solution.
- **Long-Lasting Battery** – Features rechargeable and field-replaceable battery that lasts a full shift.
- **Bluetooth Wireless Integration** – Dependable Bluetooth connection to host devices.
- **Intuitive User Indicators** – LED lights that indicate successful scanning and battery charging status.
- **Audible Scanner Feedback** – Scan tones indicate successful scans.
- **Accessories** – Charging Cable (included), Hand strap (sold separately), and Charging Dock (coming soon).
- **Easy App Integration** – Socket Mobile's Capture SDK enables easy integration in your applications to improve business productivity with fast, efficient, and reliable data transfer over Bluetooth wireless technology. Data reader works out of the box for apps that have already integrated CaptureSDK.
- **Designed and Assembled in the USA** – All socket mobile data readers are built at our headquarters in Fremont, CA.
- **1-Year Warranty Included** – Extended warranty options also available.

Physical Characteristics

Weight:

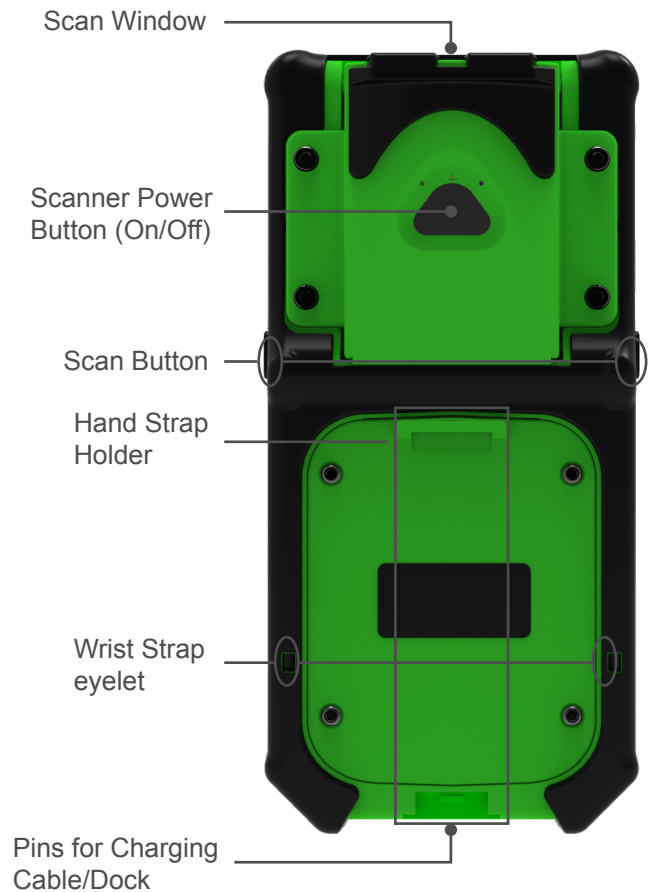
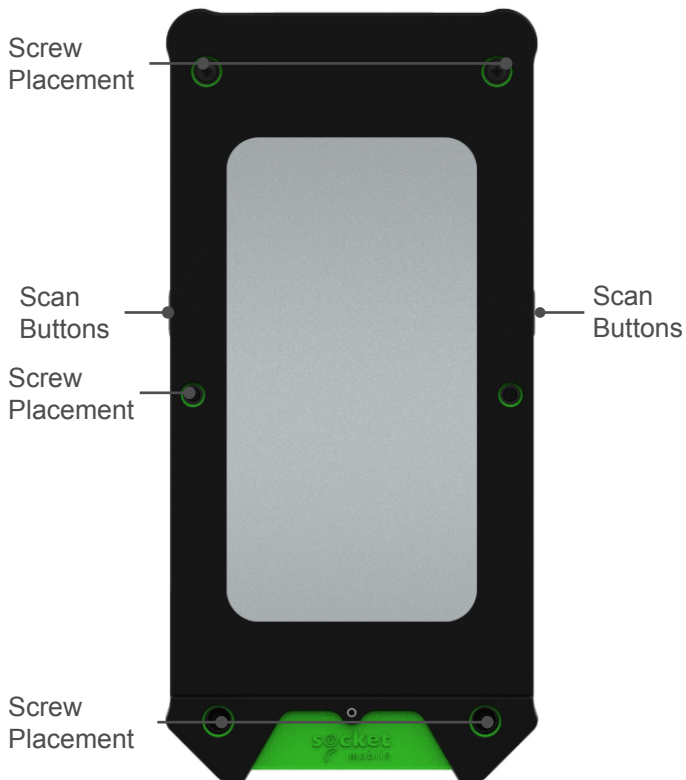

Single Package Includes

- (1) XS640 1D/2D universal barcode scanner and Rechargeable Battery (pre-installed)
- (1) Charging Cable
- (1) Wrist Strap
- (1) Get Started insert



**Socket Mobile
Companion App**
Download for Free!



Scanner Type

Technology:	1D/2D Barcode Linear Imager
Aimer:	Green LED

Battery

Type of Battery:	Replaceable Lithium Ion Polymer- rechargeable battery	
Charge Time:	8 Hours	
Battery Life	500 charge-discharge cycles	
Battery Life - Per Full Charge:	Standby time:	25 hours
	Active Scan Time -	10,000 scans within 11 hours (based on 1 scan every 4 seconds)
Note:	Battery life varies depending on ambient temperature, ambient light and age of battery. <i>For more battery information.</i>	
Number of Batteries Used:	1	
Weight of battery:	12.5g	
Percentage Lithium:	36%	
Battery mAh:	700 mAh	
Number of cells per battery:	1	
Watt Hours per battery:	2.59	
Type of Cell (ex. AA):	Proprietary	
Chemical Composition (ex. Alkaline):	Lithium - polymer	
Lithium Content:	14g	
Battery Voltage:	3.7v	
Hazmat UN Number:	UN3481, P.I. 967	
ROHS Compliance Indicator:	Yes, Included with Reader	
Battery only - Country of Origin:	China	
Commodity Code:	8507.60.0000	

Scanning Performance

Default Barcode Symbologies:

1D Symbologies: Bookland EAN, Codabar, Code 39, Code 93, Code 128, EAN-13/JAN, EAN-8/JAN, GS1 Databar, GS1 Databar Expanded, GS1 Databar Limited, GS1-128, Interleaved 2 of 5, ISBT 128, UPC A, UPC EO

2D Symbologies: Aztec, Data Matrix, DotCode, Maxicode, Micro PDF417, PDF417, QR Code

Postal Codes: Australia Post

OCR Typeface: OCR-B ICAO Travel Documents

Supported Barcode Symbologies:

1D Symbologies: Bookland EAN, Chinese 2 of 5, Codabar, Code 11, Code 39, Code 93, Code 128, Composite CC-A/B, Composite CC-C, Composite TLC, Discrete 2 of 5, EAN-13/JAN, EAN-8/JAN, GS1 Databar, GS1 Databar Expanded, GS1 Databar Limited, GS1-128, Interleaved 2 of 5, ISBT 128, ISSN EAN, Matrix 2 of 5, MSI, UPC/EAN/JAN, UPC A, UPC EO

2D Symbologies: Aztec, Data Matrix, DotCode, GS1 Data Matrix (S740 with Green scan LED only), GS1 QR Code (S740 with Green scan LED only), Maxicode, Micro PDF417, MicroQR, PDF417, QR Code

Postal Codes: Australia Post, Han Xin, Japan Postal, KIX Code, Maxicode, Netherlands, UPU FICS Posta, US Planet, US Postnet, USPS 4CB/One Code/Intelligent Mail

OCR Typeface (S740 with Green scan LED only): OCR-A, OCR-B, MICR (E13B), US currency serial number

Scan Angle: 44.5° (Horizontal) 33.5° (Vertical)

Sensor Resolution: 1280 x 960 pixels, rolling shutter

Print Contrast: Down to 25%-20%

Reading Distance:

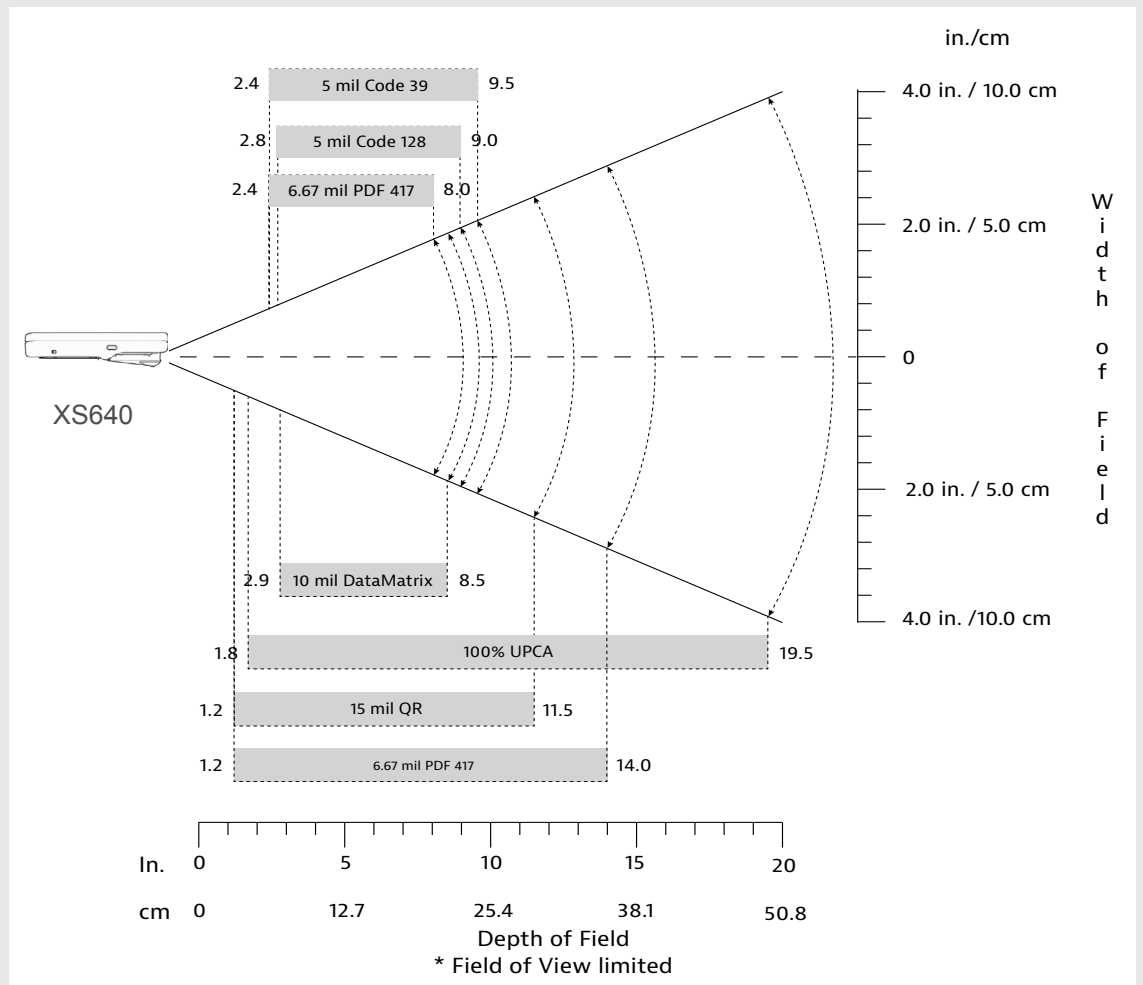

Decode Ranges:

3.0 to 49.5 cm (1.2 to 19.5 in.) Depends on barcode size, symbology, label media

	Near	Far
5 mil Code 39	2.4 in/6.1 cm	9.5 in/24.1 cm
5 mil Code 128	2.8 in/7.1 cm	9.0 in/22.9 cm
6.67 mil PDF417	2.4 in/6.1 cm	8.0 in/20.3 cm
10 mil DataMatrix	2.9 in/7.4 cm*	8.5 in/21.6 cm
100% UPCA	1.8 in/4.6 cm*	19.5 in/49.5 cm
15 mil QR	1.2 in/3.0 cm*	11.5 in/29.2 cm
20 mil QR	1.2 in/3.0 cm	14.0 in/35.6 cm

Bluetooth (wireless connection)

Bluetooth Radio:	Class 2 Bluetooth, version 2.1 + EDR (Enhanced Data Rates) with 56-bit data encryption
Bluetooth Range:	Up to 10 meters (33 ft.) depending on environment, range limit is usually due to the Host Device (phone, tablet or notebook)
Bluetooth Profiles:	Basic Mode - Human Interface Device (HID), App Mode - MFi-SPP*. Some Operating Systems or smartphone/tablet models may support only one profile. <i>*By default, the scanner is set to App Mode - MFi-SPP.</i>

Apple, Android and Windows PC with Bluetooth Classic HID are compatible with all Socket Mobile scanners.

*Chromebook and Linux support HID mode only.

User Environment

Ambient Light:	From 4,800 to 86,000 lux From artificial indoor (fluorescent and incandescent) to natural outdoor lighting (direct sunlight)
Operating Temperature:	0° to 45° C (32° to 113° F)
Storage Temperature:	-5° to 70° C (-22° to 158° F)
Charging Temperature:	Charging in an ambient temperature above 40° C / 100° F may result in charging issues.
Relative Humidity:	95% at 60° C (140° F) (non-condensing)
Sealing:	IP67 (Ingress protection rating for dust and water) meets IEC sealing and EN60529 specification
Tumble Specification:	1,000 6 ft. (1.83m) tumbles to concrete; exceeds IEC 60068-2-31, IEC60068-2-32 5,000 3.3 ft. (1m) tumbles to concrete; exceeds IEC60068-2-31, IEC60068-2-32
Drop Specification:	Standard: 10 ft. (3.1m) drop at room temperature per MIL-STD-810G, 8 ft. (2.4m) drop to concrete across temperature per MIL-STD-810G Freezer: 7 ft. (2.1m) drop to concrete across temperature per MIL-STD-810G.

Operating System Compatibility

Apple iOS - Basic Mode (HID) and App Mode (MFi-SPP)*

Compatible with devices supporting Basic Mode (HID) protocol. Supported keyboard languages - ANSI, English UK, English, French, German, Italian, Japanese, Polish, Spanish and Swedish

**By default, the factory settings of the Socket Mobile Scanners are set to App Mode. In order to use the scanner with an application using Capture SDK, the scanner must be configured in Application Mode (Bluetooth Serial Port Profile: SPP)*

Certification & Regulatory

Bluetooth SIG:	Declaration ID: D030529 QD ID: 82009
Electrical Safety:	EN 62368-1:2020 + A11:2020 IEC 62368-1:2018 UL 62368-1:2019 R10.21 CSA C22.2 NO. 62368-1:19
Environmental:	Environmental: RoHS EN 50581
EMI / RFI:	FCC Part 15 Class C, RSS 210, iCES 003, C-Tick, CISPR 22, CE EN55022, EN55024, TELEC: 020-240046 FCC ID: LUBMA41 IC ID: 2529A-MA41M9
LED Safety:	IEC 60825-1, EN 60825-1

ISO 9001 Accreditation



Warranty

Scanner:	Standard one year limited warranty for barcode scanners and case
Accessories:	90 days for batteries, charging cable
Extended Warranty: (sold separately)	https://sckt.tech/socketcare



Common Uses

Warehouse Inventory management

Supply Chain

Asset Tracking Shipping and Receiving

Commercial Services Mobile Tracking

Manufacturing

Construction

Automotive

Oil and gas

Aerospace

Transportation

socketmobile.com

Worldwide: +1 510 933 3000

North America: +1 800 552 3300

EMEA: +41 62 834 07 80

France: +33 970 462 241

sales@socketmobile.com

Asia Pacific: +1 510 933 3122

Germany: +41 62 834 07 80

Switzerland: +41 62 834 07 80

Switzerland Toll-Free: +41 (800) 898003

sales-japan@socketmobile.com

Japan: +8190 9808 0518

Japan Toll-Free: +81 (800) 9190303

Latin America: +1-510-933-3153

UK/Ireland/South Africa: +44 (800) 0487363

©2024 Socket Mobile, Inc. All rights reserved. Socket®, the Socket Mobile logo, DuraScan®, SocketScan®, Battery Friendly® are registered trademarks or trademarks of Socket Mobile, Inc. Microsoft® is a registered trademark of Microsoft Corporation in the United States and other countries. Apple®, iPad®, iPad Mini®, iPhone®, iPod Touch®, and Mac iOS® are registered trademarks of Apple, Inc., registered in the U.S. and other countries. The Bluetooth® Technology word mark and logos are registered trademarks owned by the Bluetooth SIG, Inc. and any use of such marks by Socket Mobile, Inc. is under license. Other trademarks and trade names are those of their respective owners.